

Large Span High Quality Steel Structure Prefabricated Warehouse Construction Prefab Workshop Building Modern Design Fast Install

Our Product Introduction

Basic Information

- Place of Origin: Hebei, China
- Brand Name: BAODU
- Certification: ISO9001, CE
- Model Number: Steel Warehouse
- Minimum Order Quantity: Discussible
- Price: Reasonable
- Packaging Details: In general, for steel structure, we use the steel frame packing to keep goods not to be broken. For sandwich panel and color steel sheet, we use the plastic packing. If the clients need special packing will according to their requirements.
- Delivery Time: 15-21 days
- Payment Terms: L/C, D/A, D/P, T/T, Western Union, MoneyGram
- Supply Ability: 10000 Square Meter/Square Meters per Month



Product Specification

- Product Name: Large Span High Quality Steel Structure Prefabricated Warehouse Construction Prefab Workshop Building Modern Design Fast Install
- Keyword: Steel Structure Building Warehouse
- After-sale Service: Online Technical Support
- Material: Q235/Q345 Steel
- Structure: Steel Structure Frame Welded
- Roof Cladding: EPS/Rockwool/Fiberglass Wool/PU Sandwich Panel Or Steel Sheet
- Processing Service: Bending, Welding, Decoiling, Cutting, Punching
- Productname: Prefab Steel Warehouse
- Size: According To Customer Requirement
- Installation Guide: Installation Drawings And Video
- Life Time: More Than 50 Years
- Installation time: 2-4 Weeks

Product Description

Large Span High Quality Steel Structure Prefabricated Warehouse

Hi, Dear friend, Please note that steel structure buildings are custom-designed to meet your specific requirements. If our example pictures don't match your vision, don't worry. Our team with over 20 years of experience will create the exact design, quotation, and rendering based on your building data or drawings.

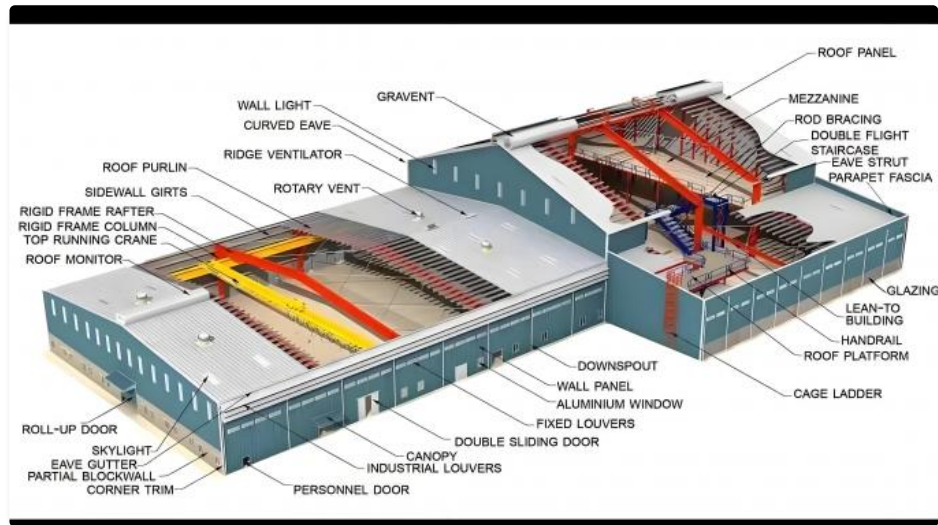

Key Features & Structural System

Primary Framework

- Columns: Hot-rolled H-section steel or welded box sections for vertical support
- Beams: H-sections or I-beams spanning between columns
- Roof Trusses/Purlins: Trusses or C/Z-section purlins supporting roof covering
- Wall Girts: Horizontal members supporting wall cladding

Secondary Elements

- Roof and Wall Cladding: Corrugated steel sheets, insulated sandwich panels
- Bracing Systems: Diagonal steel rods or cables for stability against wind and earthquakes

Connections

High-strength bolts and welding ensure robust, integrated structure connections.

Technical Parameters

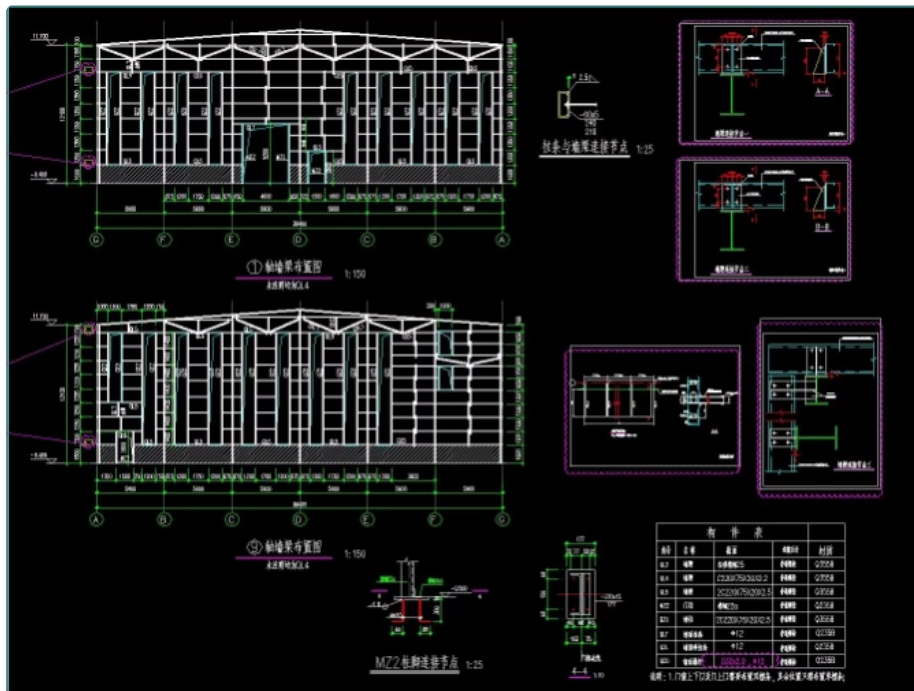

AUTODESK
AUTOCAD

PKPM 2010

3D3S

SAP2000



3DS MAX

Please provide the following information for a customized quotation and design:

Location: Country and city where building will be built

Size: Length × Width × Eave height (mm)

Wind Load: Maximum wind speed (kn/m², km/h, or m/s)

Snow Load: Maximum snow height (kn/m², mm) and temperature range

Earthquake Resistance: Required seismic level

Brick Wall: Required height (1.2m, 1.5m, or other)

Thermal Insulation: EPS, fiberglass wool, rockwool, PU sandwich panels, or metal sheets

Doors: Quantity and dimensions (width × height in mm)

Windows: Quantity and dimensions (width × height in mm)

Crane: Quantity, maximum lifting weight (tons), and lifting height (m)

Applications & Advantages



Steel structure warehouse

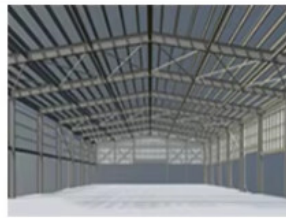

Steel structure factory building



Steel structure building



Steel structure garage/hangar



Steel structure house



Steel structure livestock house

Large Span Design: Open internal space for storage and large equipment

Fast Construction: Prefabricated components shorten construction cycle

Lightweight: Reduced foundation loads and construction costs

Excellent Seismic Performance: Superior safety under extreme conditions

Durability: Corrosion protection ensures long service life

High Flexibility: Customizable designs for different uses

Environmental Friendliness: Recyclable steel aligns with sustainability

Low Maintenance: Simple maintenance with low long-term costs

Construction Process

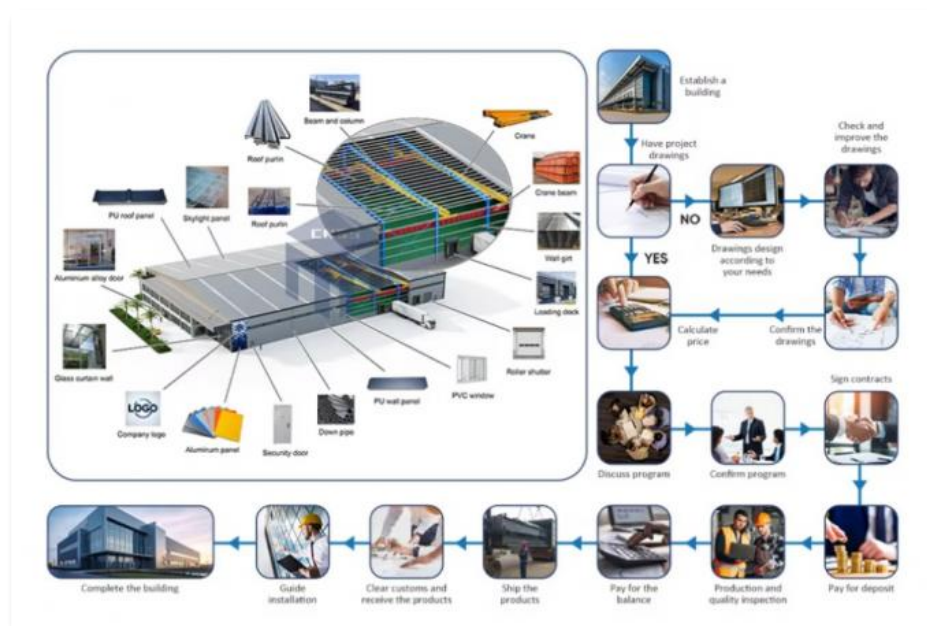

Design & Engineering: Detailed architectural and structural drawings with load calculations

Fabrication: Cutting, welding, and drilling components in factory environment

Site Preparation & Foundation: Excavation and concrete foundation pouring

Erection: Assembling primary steel frame and secondary elements

Enclosure: Installing roof, wall cladding, and insulation systems

Finishing: Adding doors, windows, ventilation, and interior finishes

Packing and Shipping





Our prefab steel warehouse components are carefully packed with secure wrapping and palletization to prevent damage during transit. Detailed assembly instructions are included for easy setup.

We offer worldwide shipping with costs varying by destination and order quantity. Contact our customer service for shipping quotes and delivery timelines.

Company Profile

Baodu International Advanced Construction Material Co., Ltd, established in 2010 with offices in Beijing and factory in Hebei, China, is a comprehensive designer, manufacturer, supplier, and exporter of industrial noise treatment, steel structures, sandwich panels, and prefab houses.

Annual production capacity includes 6 million square meters of acoustic sandwich panels, 100,000 tons of steel structures, and 1 million square meters of floor decking sheet, serving over 30 countries worldwide.

Our professional design team includes 5 senior engineers, 20 engineers, and 35 technicians with over 10 years' experience. We hold energy-saving intellectual property rights, construction qualifications, CE certification, and Russian GOST certification.

Notable projects include China's 60th anniversary military parade village, Beijing Daxing International Airport, Thar Pakistan coal-fired power plant, and Hasyan Dubai power plant.

Frequently Asked Questions

Q: Are you a manufacturing factory or a foreign trade company?

A: We are an integrated enterprise of industry and trade, combining steel structure building design optimization, fabrication, installation, and service. We invite you to visit our factory for customized solutions.

Q: Does the steel used by your company meet international quality standards? How to ensure material durability?

A: We use high-quality steel materials meeting customer standards or exceeding GB national standards (e.g., Q355B high-strength steel). All materials include manufacturer certificates and third-party test reports. We ensure durability through hot-dip galvanizing, fireproof coating, and other processes.

Q: Where can your steel structure be used?

A: Our steel structure systems are widely used in intelligent factories, manufacturing workshops, logistics centers, shopping malls, office buildings, stadiums, exhibition centers, photovoltaic power stations, wind towers, airport terminals, high-speed rail stations, modular buildings, greenhouses, poultry houses, light steel villas, bridges, and other buildings.

Q: What are the core advantages of steel structure building compared with concrete structure?

A: High strength-to-weight ratio: 40% weight reduction, lower foundation cost; Short construction cycle: no maintenance period, construction in rainy seasons; Environmentally friendly and recyclable: 90% steel recycling rate, 75% dust pollution reduction. Particularly suitable for warehouses and multi-storey factories with large-span space requirements.

Q: Is the maintenance cost of steel structure plant high? What routine maintenance is needed?

A: Annual maintenance cost is only 0.8%-1.2% of construction cost, including: Checking bolt tightness and rustproof layer every 2 years, fire retardant coating every 5 years, and drainage system inspection after storms.



Baodu International Advanced Construction Material Co., Ltd.



+86 13717927965



chunlei.song@baodu.com



baodupanel.com

No. 2, Yijin North Street, Daxing District, Beijing