

Fast Install Assembly Prefabricated Steel Warehouse Custom Design

Our Product Introduction

for more products please visit us on baodupanel.com

Basic Information

- Place of Origin: Hebei, China
- Brand Name: BAODU
- Certification: ISO9001, CE
- Model Number: Steel Warehouse
- Minimum Order Quantity: 300 square meters
- Price: \$24-38 square meter
- Packaging Details: In general, for steel structure, we use the steel frame packing to keep goods not to be broken. For sandwich panel and color steel sheet, we use the plastic packing. If the clients need special packing will according to their requirements.
- Delivery Time: 30 days
- Payment Terms: L/C, D/A, D/P, T/T, Western Union, MoneyGram
- Supply Ability: 100000 Square Meter/Square Meters per Month



Product Specification

- Product Name: China Factory Fast Install Prefab Steel Structure Assembly Custom Design Building
Prefab Warehouse Steel Structure High-quality Steel Structure Warehouse/Industrial Steel Structure Warehouse
- Warranty: 50 - 100 Year
- Installation: Engineer Guidance
- Surface Treatment: Painting Or Galvanized
- Processing Service: Bending, Welding, Decoiling, Cutting, Punching
- Application Fields: Warehouse, Factory, Steel Structure Building
- Environmental Impact: Eco-friendly
- Frame: Weld Steel Structure Frame
- Installation Guide: Installation Drawings And Video

Product Description

China Factory Fast Install Prefab Steel Structure Assembly Custom Design Building Prefab Warehouse Steel Structure High-quality Steel Structure Warehouse/Industrial Steel Structure Warehouse

Features:



Compared with traditional buildings, steel structure building is a new building structure— the entire building made of steel. The structure mainly comprises steel beams, columns, trusses, and other parts made of section steel and steel plates. It is connected between parts and parts by welding, bolts, and rivets. The lightweight and simple structures are widely used in large factories, stadiums, super high-rise buildings, and other fields. The type of steel building structure includes the portal rigid steel frame, frame structure, truss structure, and grid structure.

Feature and application of the standard type of steel building structure:

1. Portal frame structure has simple force, clear force transmission path, and fast construction speed. It is widely used in industrial and civil buildings such as industrial, commercial, cultural, and entertainment public facilities.
2. Steel building frame structures are flexible and can form a larger space. It is widely used in the multi-story and high-rise building such as commercial office building, shopping mall, conference center and other buildings.
3. Steel truss structure is using small cross-section tube to form larger cross-section components, which are often used in industrial and civil buildings such as large span roof, bridge, tower, marine oil production platform, etc., with large span or height in the building.
4. The steel grid structure is a high-order statically indeterminate space structure composed of many rods according to certain rules with small space stress, lightweight, high rigidity, and excellent seismic resistance. It can be used as a gymnasium, exhibition hall, petrol station and hangars, etc.

Member	Steel Column	Warranty	30-50 Years Service Life
Carbon Structural Steel	Q355	Type	H-Section Steel
Application	Steel Workshop, Steel Structure Platform, Steel Fabricated House, Structural Roofing, Frame Part, Steel Walkway and Floor, Steel Structure Bridge, Steel Workshop, Warehouse, Department, Steel Hangars	Standard	ASTM
		Trademark	Carbon Structural Steel
		Forming	Hot-Rolled Steel

		Material	Steel Structure
Structure Frame	Portal Frame	Software We Used	Auto CAD, Pkpm, Tekla
Steel Code	Q355 & Q235	H Steel Type	Hot Rolled H-Beam or Welded H Beam
Wind Loading	80km/H-120km/H, or as Client's Requirement	Snow Loading	as Per Customer's Requirements
Seismic Grade	7 Grade	Connection Method	Bolts Connection
Cladding Materials	Single Corrugated Steel Sheet, Sandwich Panels	Structure Surface Treatment	Any Color Painting or Hot Galvanize
Origin	Hebei, China	Specification	Customized Size
Production Capacity	2000 Tons Per Month	Residential Structure Wall	Sandwich Panels
Connection Form	Bolt Connection	Customized	Customized
Type of Steel For Building Structure	H Beam Steel	HS Code	9406000090 or 7308900000

Technical Parameters:

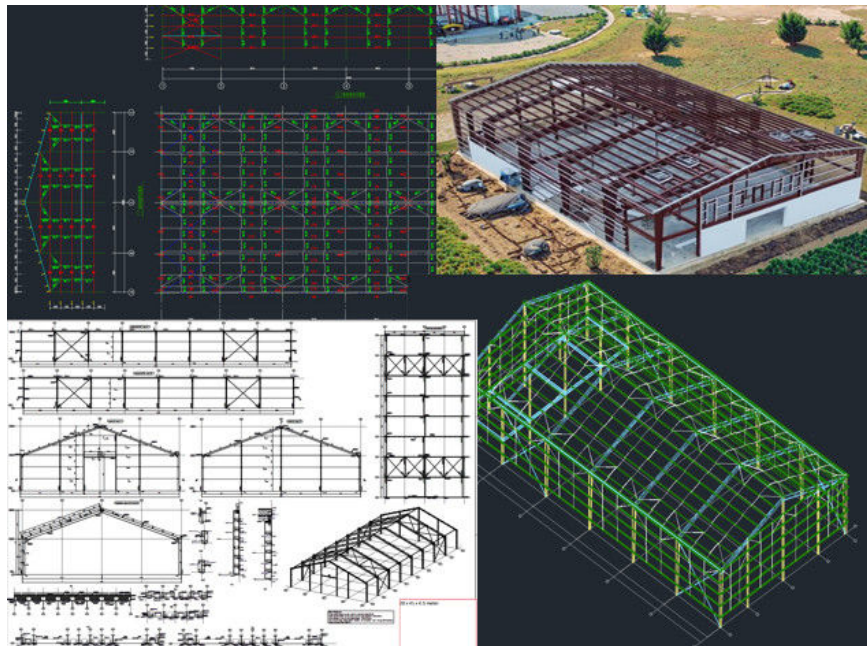

Please kindly inform us of the information below if you are interested in our products.

- 1. Project Progress:** Is Land Purchased? Is it licensed by the government?
- 2. Usage:** for warehouse, workshop, showroom, etc.
- 3. Location:** In which country will it be built?
- 4. Local Climate:** Wind speed, Snow load (max. Wind speed)
- 5. Design:** Please provide the design drawing. Or do you need us to design for you?
- 6. Dimension:** Length*width*height
- 7. Crane Beam:** Do you need crane beam inside the steel structure?
- 8. Roof and Wall:** determine the panel material, such as color steel panel, and metal sandwich panel.

9. Windows and Doors: what material, quantity, and type?

Components:

Roof and wall project system

The roof and wall system plays a vital role in protecting your structure from environmental factors like wind, rain, and temperature fluctuations. With advanced insulation and weatherproofing, our systems ensure durability and energy efficiency.

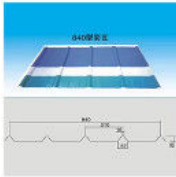

Connected Steel Sheet

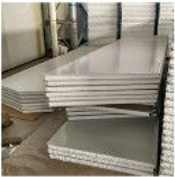

EPS Sandwich Panel

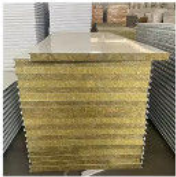

Rock Wool Sandwich Panel

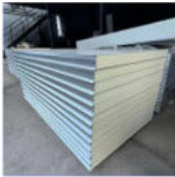

PU Sandwich Panel

Main Steel Frame

At the core of every steel structure is the main steel frame, which provides the strength and stability necessary to support the entire building. Our frames are designed for durability, ensuring that your structure can withstand even the most demanding conditions.



Steel Column Steel Beam Wind Resist Column



Connected Plate



Tie Bar



Roof Purlin



Horizontal Support

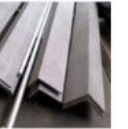

L Shape Steel for Bracing

Other Materials

Every steel structure project requires a range of additional materials to ensure its functionality and performance. From accessories to safety-enhancing features, we offer everything you need to complete your structure.



Covering Accessories



Water Gutter



Embedded Bolts



Turnuckles Bolts



High Strength Bolts



Normal Bolts



Steel Rod



Rolling Gate



Automatic Machine for Rolling Door



Canopy



Ventilation Materials



Ventilation Materials



Steel Door for Man



Aluminum Sliding Window

Steel Building Process:

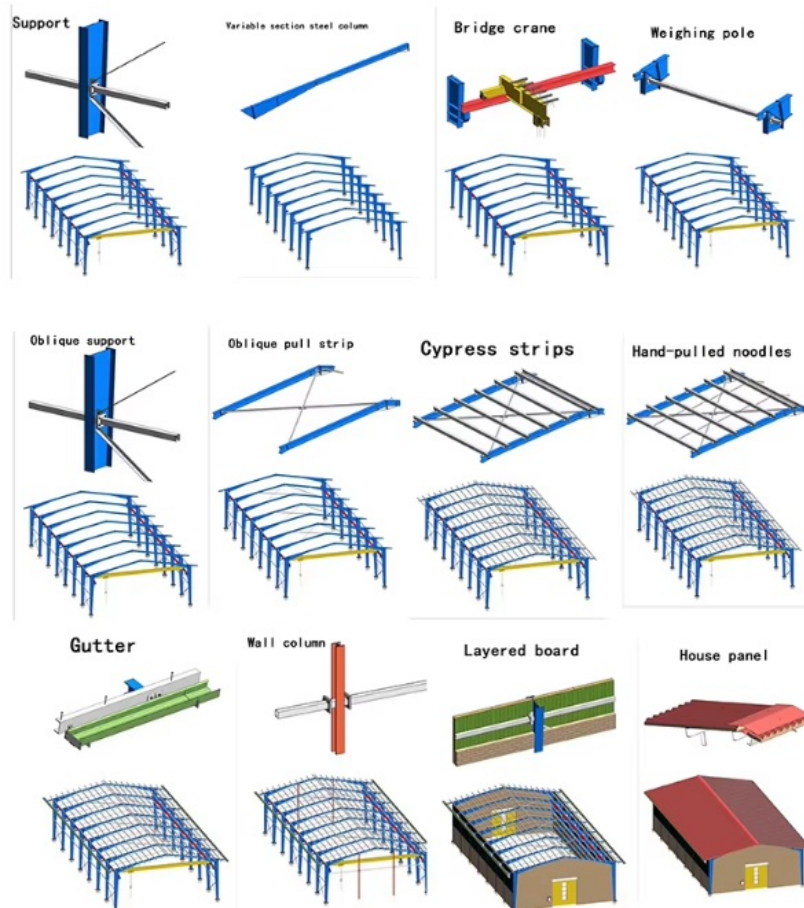

Project Cases:









Applications	
Our steel factory buildings are widely used in manufacturing, logistics, energy, and processing industries.	
Industry	Applications
Manufacturing	Automobile assembly, metal fabrication, electronics production
Logistics & Warehousing	Storage hubs, distribution centers
Food Processing	Meat packaging, dairy production, cold storage
Mining & Energy	Heavy-duty workshops, oil & gas processing

Strict Quality Inspection Standards



Excellent product quality is our eternal pursuit, and it is also the fundamental reason for us to base ourselves on the global market. BAODU GROUP implements whole-process quality management and strictly supervises every process such as raw material supply, engineering design, steel component manufacturing, installation and construction.

We have established a professional team of quality inspection engineers, introduced internationally leading quality inspection equipment such as German GS1000 vacuum spectrometer and high-frequency infrared carbon sulfur analyzer, established a high-quality product inspection room, and won many awards from China's advanced quality management unit.

In addition, we support testing and certification by SGS, TUV, BV.

Our capacity and certification:

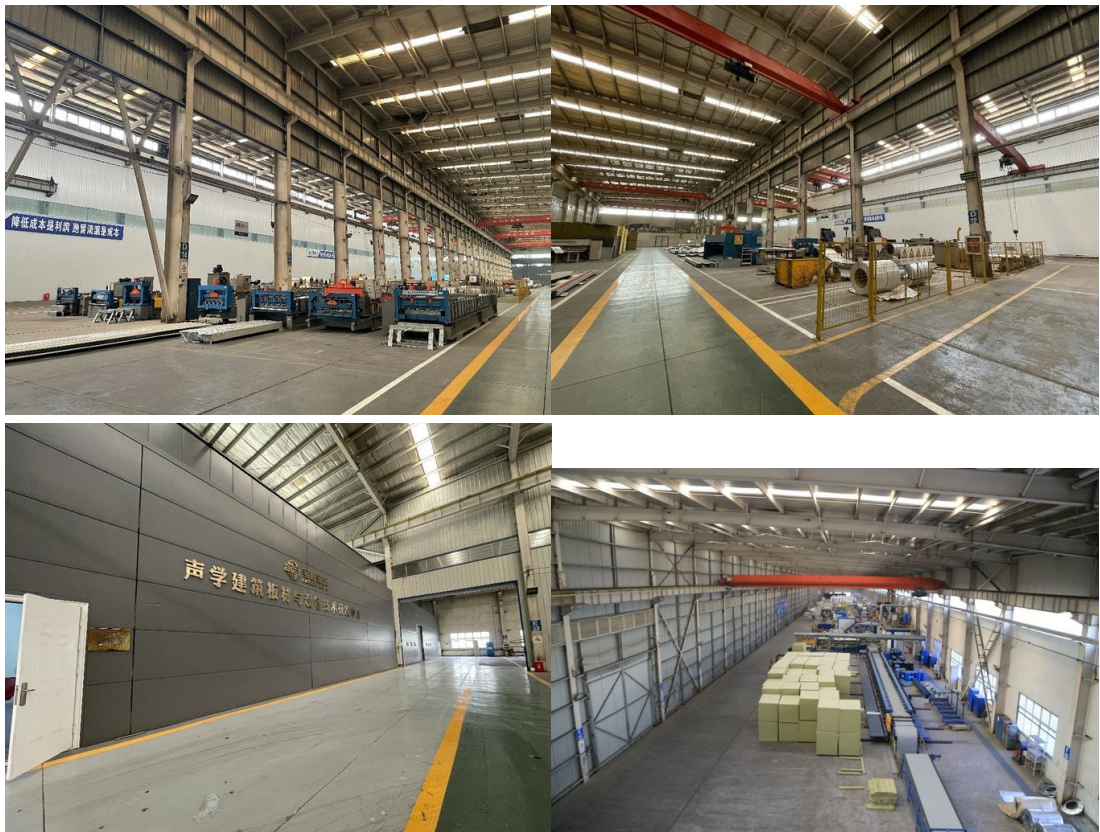

OUR CERTIFICATE



Support and Services:



Why Choose Our Steel Structure Factory Buildings?

Our industrial steel structures are engineered for maximum efficiency, cost-effectiveness, and long-term durability.

1. Large-Span, Column-Free Interiors
 - Eliminates obstructive columns, allowing flexible production layouts.
2. High-Strength Steel Framework
 - Built with Q355/Q235 high-strength steel, ensuring superior load-bearing capacity.
3. Fast Construction & Cost Efficiency
 - Prefabricated components reduce installation time by 40%-60% compared to concrete buildings.
4. Energy-Efficient & Climate-Resilient
 - Integrated ventilation, skylights, and air circulation systems ensure a comfortable work environment.
5. Customizable & Scalable Solutions
 - Designed for multi-story expansion, incorporating mezzanines, crane beams, and fire-resistant materials.

Company profile:

Baodu International Advanced Construction Material Co., Ltd was established in January 2010 with the office in Beijing and factory in Hebei, China. Baodu is a designer, manufacturer, supplier and exporter of industrial noise comprehensive treatment, steel structure, sandwich panel and prefab house. Baodu has an annual output of 6 million square meters of acoustic sandwich panels, 100000 tons of steel structures and 1 million square meters of floor decking sheet. The products are sold in more than 30 countries and regions around the world. Baodu has a professional design team with more than 10 years' experience, including 5 senior engineers, 20 engineers, and 35 technicians. Baodu has several energy saving and environment protection intellectual property rights, construction and environment protection design qualification, CE certification and Russian GOST certification etc. Baodu participated in the military parade village project for the 60th anniversary of China and project of Beijing Daxing International Airport. Under the guidance of China's "one belt, one road" strategy, Baodu has also undertaken overseas projects such as the project of Thar, Pakistan coal fired power plant, Hasyan Dubai power plant and so on. Finally, welcome your coming to Baodu for a visit and cooperation!

Packing and Shipping:



Packaging Details :

1.Steel structure components will be in packaging with proper protection.

2.Sandwich panels will be covered with plastic film.

3.Bolts and other accessories will be loaded into wooden Boxes

All the structure components, panels, bolts and sorts of accessories will be well packed with standard package suitable for ocean transport and loaded into 40'HQ.

All the products are loaded at the loading site of our factory using crane and forklift by our skilled workers, who will prevent the goods to be damaged.

Good relationship with many vessel companies to make sure the transportation smooth



Baodu International Advanced Construction Material Co., Ltd.



+86 13717927965



chunlei.song@baodu.com



baodupanel.com

Room 1101, Building 6, Yard 9, Hongye Road, Daxing District, Beijing