

## Custom Prefab Metal Warehouse Construction Modular Industrial

### Our Product Introduction

for more products please visit us on [baodupanel.com](http://baodupanel.com)

#### Basic Information

- Place of Origin: Hebei, China
- Brand Name: BAODU
- Certification: ISO9001, CE
- Model Number: Steel Warehouse
- Minimum Order Quantity: 100 square meters
- Price: CN¥200-330/square meter
- Packaging Details: In general, for steel structure, we use the steel frame packing to keep goods not to be broken. For sandwich panel and color steel sheet, we use the plastic packing. If the clients need special packing will according to their requirements.
- Delivery Time: 30 days
- Payment Terms: L/C, D/A, D/P, T/T, Western Union, MoneyGram
- Supply Ability: 10000 Square Meter/Square Meters per Month



#### Product Specification

- Product Name: Custom Construction Modular Industrial Steel Structure Factory Building Metal Prefab Warehouse
- Main Frame: Welded H Steel Beam, Steel Truss
- Installation: Engineer Guidance
- Surface Treatment: Painting Or Galvanized
- Processing Service: Bending, Welding, Decoiling, Cutting, Punching
- Application Fields: Warehouse, Factory, Steel Structure Building
- Secondary Frame: C&Z Purlin, Brace
- Installation Guide: Installation Drawings And Video
- Foundation: Bolt-Connected Precast Concrete Base
- Model Number: Steel Structure Q345/Q355 Steel & Q235 Steel

## Product Description

### Custom Construction Modular Industrial Steel Structure Factory Building Metal Prefab Warehouse

#### Features:

Steel structure building is new type building structure, structure formed by steel column, beam, bracing and purlin, all the components are prefabricated manufactured in workshop and ready for assembling, wall and roof materials could use Single color sheet or sandwich panel, all the steel structure components connected by bolt, easy installation and quickly finished A steel structure warehouse is a building or storage facility made mostly with steel components, featuring high strength, durability, quick and easy construction, large clear spans, and customizability. It's commonly used to store different industries' goods, equipment, or materials.

#### Technical Parameters:

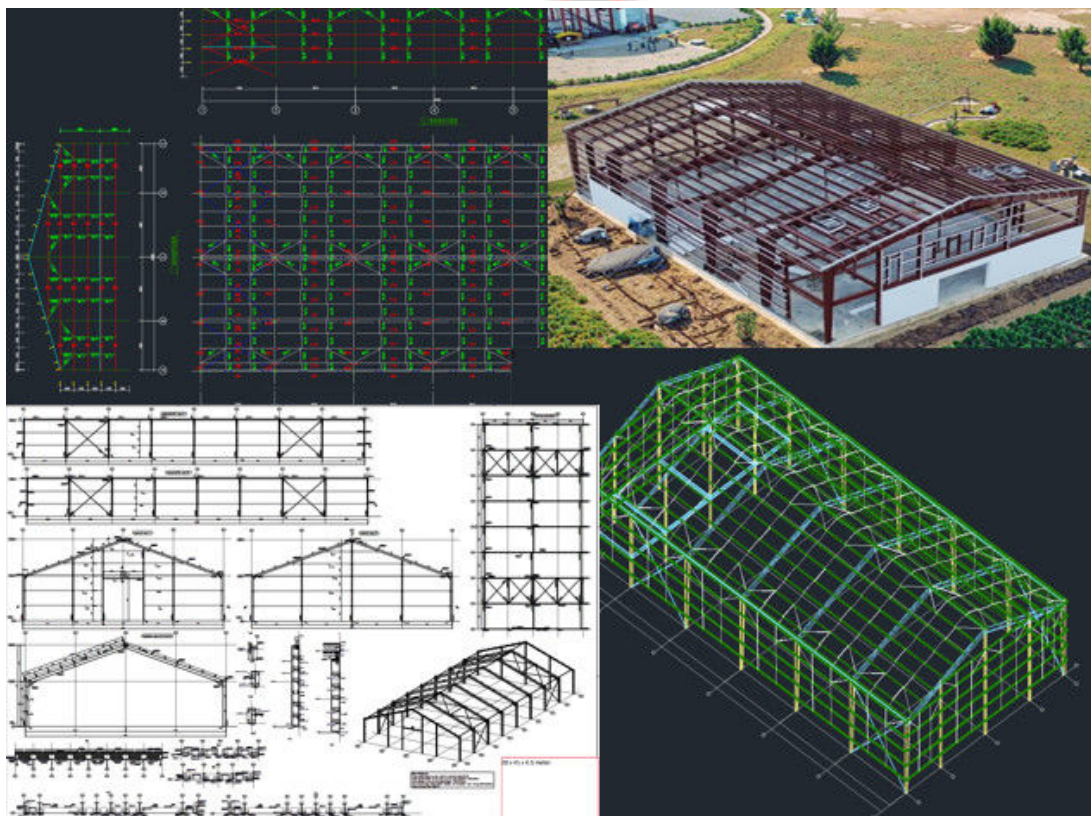

Please kindly inform us of the information below if you are interested in our products.

1. Project Progress: Is Land Purchased? Is it licensed by the government?
2. Usage: for warehouse, workshop, showroom, etc.
3. Location: In which country will it be built?
4. Local Climate: Wind speed, Snow load (max. Wind speed)
5. Design: Please provide the design drawing. Or do you need us to design for you?
6. Dimension: Length\*width\*height
7. Crane Beam: Do you need crane beam inside the steel structure?
8. Roof and Wall: determine the panel material, such as color steel panel, and metal sandwich panel.
9. Windows and Doors: what material, quantity, and type?

#### Steel Materials List:



Main steel frame	H section steel beam and columns ,Glavanized C purlin,Glavanized square pipe
Surface	Painted or Hot Dip Galvanized
Roof & Wall Panel	Sandwich Panel / Corrugated Steel Sheet, daylight panel
Window	PVC Steel or Aluminum Alloy Window
Door	Rolled up door / sliding door/ Insulated safety door
Other accessory	Roof Gutter ;Rainspout ;Roof Ventilator
Service	Design, Fabrication, Installation and after-sale service
	We can make quotation according to customer's drawing or detailed requirement; (size by length/width/height and wind speed), offering a free design drawing and all detailed drawings for installation.
	Design software: Auto CAD, PKPM, MTS, 3D3S, Tarch, Tekla Structures (Xsteel)V12.0.etc

## Steel Building Process:

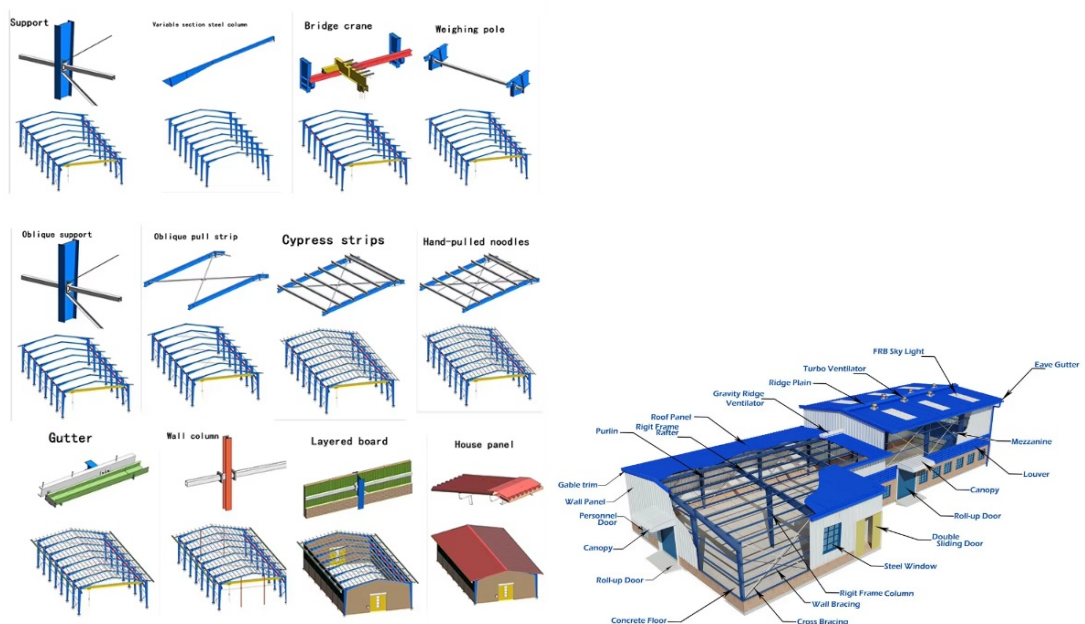

## Project Cases:







- Building Purpose:  
we will recommend the best design for the purpose of the building.
- A. Warehouse/Storage
  - B. Factory
  - C. Agriculture Barn
  - D. Retail Store
  - E. Repair/Mechanic Shop
  - F. Office Space
  - G. Medical Warehouse
  - H. Animal Farm (please confirm what kind of animal)

**Our capacity and certification:**



## OUR CERTIFICATE

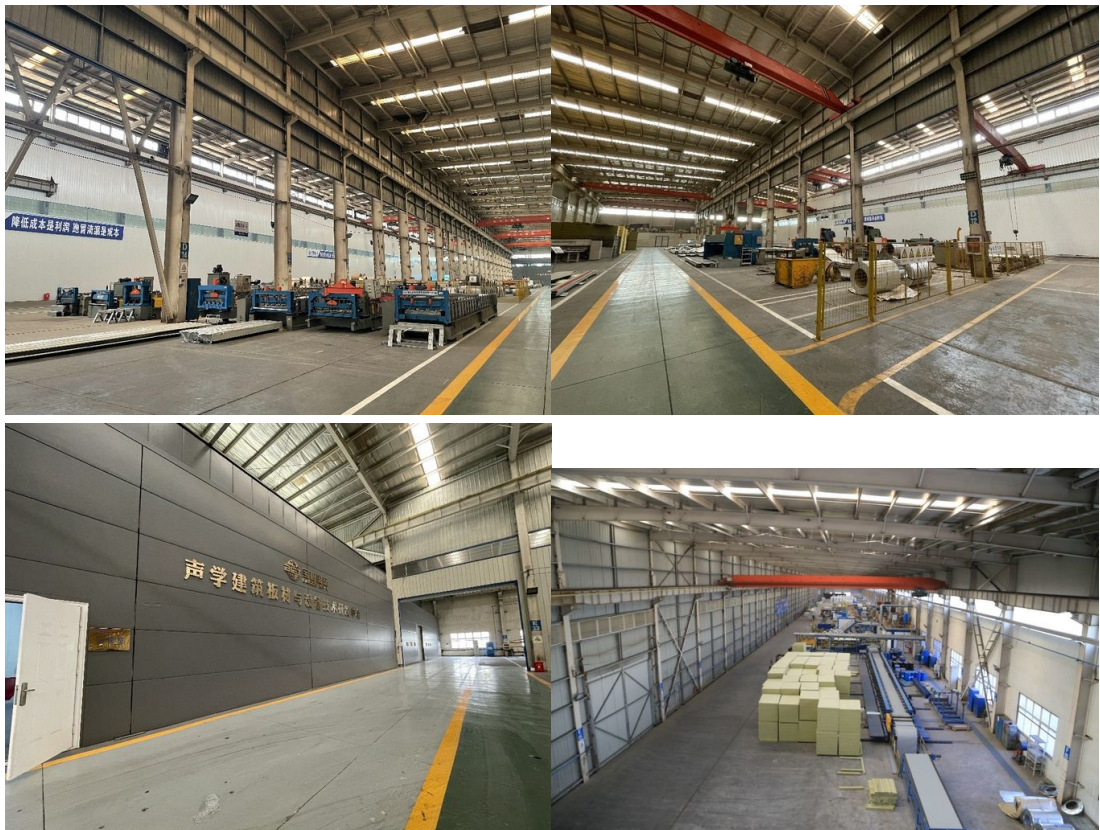

Support and Services:





### Company profile:

Baodu International Advanced Construction Material Co., Ltd was established in January 2010 with the office in Beijing and factory in Hebei, China. Baodu is a designer, manufacturer, supplier and exporter of industrial noise comprehensive treatment, steel structure, sandwich panel and prefab house. Baodu has an annual output of 6 million square meters of acoustic sandwich panels, 100000 tons of steel structures and 1 million square meters of floor decking sheet. The products are sold in more than 30 countries and regions around the world. Baodu has a professional design team with more than 10 years' experience, including 5 senior engineers, 20 engineers, and 35 technicians. Baodu has several energy saving and environment protection intellectual property rights, construction and environment protection design qualification, CE certification and Russian GOST certification etc. Baodu participated in the military parade village project for the 60th anniversary of China and project of Beijing Daxing International Airport. Under the guidance of China's "one belt, one road" strategy, Baodu has also undertaken overseas projects such as the project of Thar,Pakistan coal fired power plant, Hasyan Dubai power plant and so on. Finally, welcome your coming to Baodu for a visit and cooperation!

### Packing and Shipping:



#### Product Packaging:

The Prefab Steel Warehouse will be securely packaged in durable materials to ensure safe delivery. Each component will be carefully wrapped and protected to prevent any damage during transportation.

#### Shipping:

We offer reliable shipping services for the Prefab Steel Warehouse product. Once your order is confirmed, our team will arrange for prompt delivery to your specified location. You can track the shipment and expect timely updates on the estimated time of arrival.

#### FAQ

Q: What is the brand name of this product?

A: The brand name is BAODU.

Q: Where is the Prefab Steel Warehouse manufactured?

A: The Prefab Steel Warehouse is manufactured in Hebei, China.

Q: What certifications does the Steel Warehouse have?

A: The Steel Warehouse is certified with ISO9001 and CE.

Q: What are the packaging details for this product?

A: In general, for steel structure, we use steel frame packing to prevent breakage. For sandwich panel and color steel sheet, we use plastic packing. Special packing can be arranged according to client requirements.

Q: What are the accepted payment terms for purchasing the Steel Warehouse?

A: The accepted payment terms include L/C, D/A, D/P, T/T, Western Union, and MoneyGram.



**Baodu International Advanced Construction Material Co., Ltd.**



+86 13717927965



chunlei.song@baodu.com



baodupanel.com

Room 1101, Building 6, Yard 9, Hongye Road, Daxing District, Beijing