

Customizable and Affordable Low Cost Prefabricated Prefab Steel Structure Building Warehouse

Our Product Introduction

for more products please visit us on baodupanel.com

Basic Information

- Place of Origin: Hebei, China
- Brand Name: BAODU
- Certification: ISO9001, CE
- Model Number: Steel Warehouse
- Minimum Order Quantity: 20 Tons
- Price: Reasonable
- Packaging Details: In general, for steel structure, we use the steel frame packing to keep goods not to be broken. For sandwich panel and color steel sheet, we use the plastic packing. If the clients need special packing will according to their requirements.
- Delivery Time: 21 days
- Payment Terms: L/C, D/A, D/P, T/T, Western Union, MoneyGram
- Supply Ability: 5000 Tons per Month



Product Specification

- Product Name: Customizable And Affordable Low Cost Prefabricated Prefab Steel Structure Building Warehouse
- Warranty: 50 Years
- Wall Cladding: EPS/Rockwool/Fiberglass Wool/PU Sandwich Panel Or Steel Sheet
- Tolerance: $\pm 1\%$
- Application: Steel Storage, factory Or Logistic Warehouse
- Durability: High
- Roof Cladding: EPS/Rockwool/Fiberglass Wool/PU Sandwich Panel Or Steel Sheet
- Drawing Design: SAP2000/AutoCAD /PKPM /3D3S/TEKLA
- Type: Light Steel Structure
- Design Style: Modern

Product Description

Customizable and Affordable Low Cost Prefabricated Prefab Steel Structure Building Warehouse

Product Description:

Warehouse

Steel structure warehouse feature:

1. Light weight, high strength, large span;
2. Quality certification ISO:9001:2008
3. Used widely, used as factory, warehouse, office building, aircraft hangar etc;
4. Easy move, recycle, environmentally;
5. Short construction period, lower cost;
6. Structural durabilities, easy maintenance.

Workshop

Characteristics of steel structure

workshop

1. lightweight high strength, large area;
2. Quality certification ISO:9001:2008
3. Short construction period, lower cost;
4. Easy move, recycle, environmentally;
5. Used widely used as factory warehouse office building, aircraft hangar etc;
6. Structural durables, easy maintenance.



Features:

Main steel Frame	H section steel beam and column, painted (epoxy zinc or alkyd paint) or galvanized;
Secondary Frame	Tie tube, knee brace, strutting piece, roof horizontal bracing, wall bracing, Casing, purlin etc;
Roof/wall protect system	Single steel plate/ EPS&PU&FIBERGLASS&ROCKWOOL sandwich panel etc;
Drawing	Auto CAD, 3D3S, sketchup, Tekla etc;
Certifications	ISO 9001, CE, IIW;
Standard	GB
Steel grade	Q235, Q355 etc;
Structure usage	Up to 30-50 years

Technical Parameters:



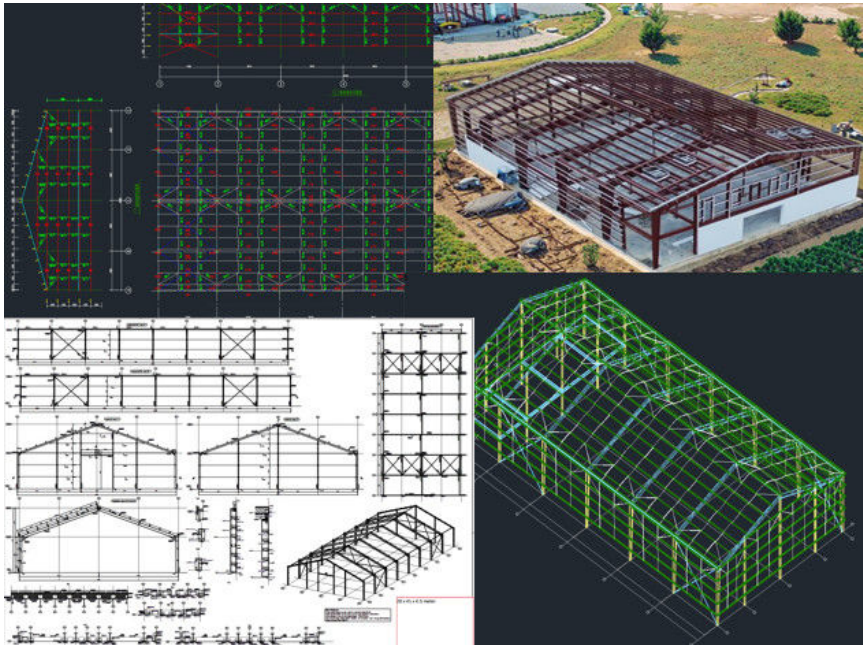

If you are interested in our steel structure , please give us the following information:

- 1 Location (where will be built?) _____country, area
- 2 Size: Length*width*height _____mm*_____mm*_____mm
- 3 wind load (max. Wind speed) _____kn/m2, _____km/h, _____m/s
- 4 snow load (max. Snow height)_____kn/m2, _____mm
- 5 anti-earthquake _____level
- 6 brickwall needed or not If yes, 1.2m high or 1.5m high
- 7 thermal insulation If yes, EPS, fiberglass wool, rockwool, PU sandwich panels will be suggested; If not, the metal steel sheets will be ok. The cost of the latter will be much lower than that of the former.
- 8 door quantity & size _____units, _____(width)mm*_____(height)mm
- 9 window quantity & size _____units, _____(width)mm*_____(height)mm
- 10 crane needed or not If yes, _____units, max. Lifting weight_____tons; Max. Lifting height _____m.

Applications:



STEEL STRUCTURE WORKSHOP



STEEL STRUCTURE WAREHOUSE



STEEL STRUCTURE HANGAR



CHICKEN POULTRY HOUSE



PREFAB HOUSE

BAODU Prefab Steel Warehouse is a versatile and reliable solution for various product application occasions and scenarios. With its durable construction and high-quality materials, this steel warehouse is suitable for a wide range of purposes. Whether you need a building for galvanized storage, light steel building, workshop industrial steel, or any other commercial or industrial use, the BAODU Steel Warehouse is an ideal choice.

Manufactured in Hebei, China, this steel warehouse meets the highest standards of quality and safety. It is certified with ISO9001 and CE, ensuring that it complies with all relevant regulations and requirements. The minimum order quantity is discussible, making it easy to tailor the purchase to your specific needs.

With a reasonable price and excellent packaging details, the BAODU Steel Warehouse offers great value for money. The steel frame packing ensures that the goods are protected during transportation, while the plastic packing for sandwich panels and color steel sheets keeps them secure. Special packing options are also available upon request.

Delivery time for the BAODU Steel Warehouse is just 21 days, allowing for quick and efficient installation. Multiple payment terms are accepted, including L/C, D/A, D/P, T/T, Western Union, and MoneyGram, making the purchasing process convenient for customers. The supply ability of 10000 square meters per month ensures that orders can be fulfilled promptly.

With a tolerance of $\pm 1\%$, the BAODU Steel Warehouse is designed to meet strict accuracy requirements. The wall cladding options include EPS, Rockwool, Fiberglass Wool, PU Sandwich Panel, or Steel Sheet, providing flexibility for different preferences. The aluminum alloy and plastic steel windows offer both durability and aesthetics.

Installation of the BAODU Steel Warehouse is easy and straightforward, making it a practical choice for various construction projects. Whether you need a storage facility, workshop, or industrial building, this prefabricated steel warehouse delivers reliable performance and long-lasting quality.

Customization:

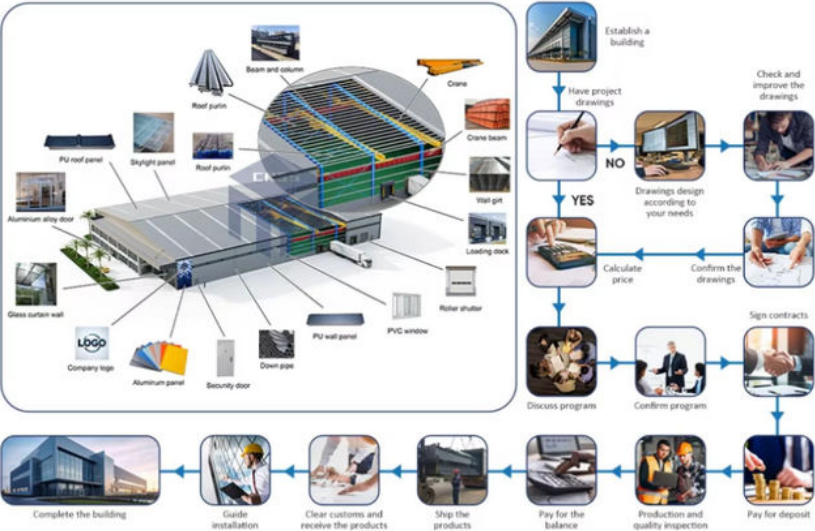

Products materials



Embedded bolts
for foundation



Structure frame
for columns or
beams

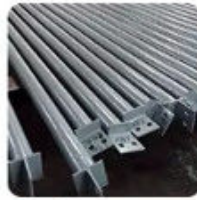

Bracing material



Connected plate



Purlin



Cladding material
1 -steel sheet



Cladding material
2- EPS panel



Cladding material
3-glass wool panel



Cladding material
4-rock wool panel



Door option
1-sliding door



Cladding material
2-rolling door



Aluminum window

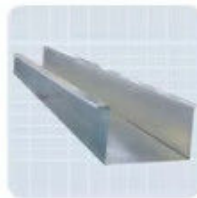

Water gutter



Water pipe



Sealing materi



Ventilation
equipment on roof



FRP panel for
lighting



Bolts



Steel decking



Stair (if neede

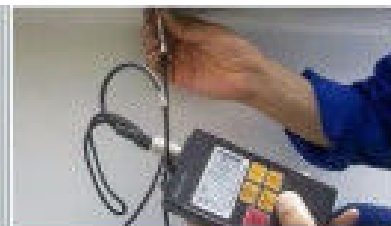

Support and Services:

The Product Technical Support and Services for the Prefab Steel Warehouse include:

- Assistance with assembly and installation instructions
- Troubleshooting guidance for any structural issues
- Information on maintenance and upkeep of the steel components
- Consultation on customization options for specific project requirements

Packing and Shipping:



Product Packaging:

Our Prefab Steel Warehouse is carefully packaged to ensure safe transportation and delivery. Each component is securely wrapped and labeled for easy identification during the assembly process.

Shipping:

We offer worldwide shipping for our Prefab Steel Warehouse. Our logistics team works diligently to arrange efficient transport and ensure timely delivery to your desired location. Shipping fees may vary depending on the delivery destination and order quantity.

FAQ:

Q: What is the brand name of the Prefab Steel Warehouse?

A: The brand name is BAODU.

Q: What is the model number of the Prefab Steel Warehouse?

A: The model number is Steel Warehouse.

Q: Where is the Prefab Steel Warehouse manufactured?

A: The Prefab Steel Warehouse is manufactured in Hebei, China.

Q: What certifications does the Prefab Steel Warehouse have?

A: The Prefab Steel Warehouse is certified with ISO9001 and CE.

Q: What are the payment terms accepted for purchasing the Prefab Steel Warehouse?

A: The accepted payment terms include L/C, D/A, D/P, T/T, Western Union, and MoneyGram.



Baodu International Advanced Construction Material Co., Ltd.



+86 13717927965



chunlei.song@baodu.com



baodupanel.com

Room 1101, Building 6, Yard 9, Hongye Road, Daxing District, Beijing