

Low Cost Livestock Shelter Dairy Farm Barn Steel Structure Cow Shed For Live Cattle

Our Product Introduction

for more products please visit us on baodupanel.com

Basic Information

- Place of Origin: Hebei, China
- Brand Name: BAODU
- Certification: ISO9001, CE
- Model Number: Steel Warehouse
- Minimum Order Quantity: Discussible
- Price: Reasonable
- Packaging Details: In general, for steel structure, we use the steel frame packing to keep goods not to be broken. For sandwich panel and color steel sheet, we use the plastic packing. If the clients need special packing will according to their requirements.
- Delivery Time: 21 days
- Payment Terms: L/C, D/A, D/P, T/T, Western Union, MoneyGram
- Supply Ability: 10000 Square Meter/Square Meters per Month



Product Specification

- Product Name: Low Cost Livestock Shelter Dairy Farm Barn Steel Structure Cow Shed For Live Cattle
- Surface Treatment: Hot Dip Galvanised Or Painted
- Weather Resistance: High
- Durability: High
- Fire Resistance: High
- Wall Cladding: EPS/Rockwool/Fiberglass Wool/PU Sandwich Panel Or Steel Sheet
- Tolerance: $\pm 1\%$
- Roof Cladding: EPS/Rockwool/Fiberglass Wool/PU Sandwich Panel Or Steel Sheet
- Design Style: Industrial
- Keyword: Dairy Farm Steel Structure
- Highlight: Live Cattle Cow Shed

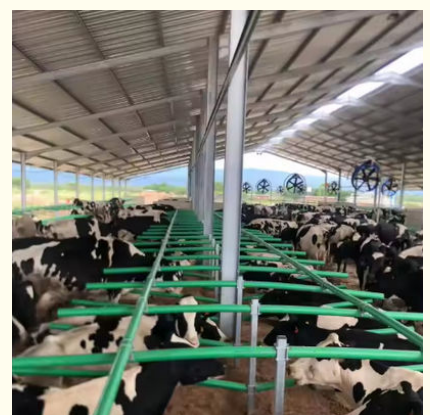

Product Description

Low Cost Livestock Shelter Dairy Farm Barn Steel Structure Cow Shed for Live Cattle

Product Description:



Overall structure

Our cattle(cow) shed adopts a stable and reliable steel frame to ensure its firmness, durability and safety. our design fully considered the living habits of cattle(cow), the needs of breeding management and environmental conditions.

Customized service

Our cattle(cow) shed is not only produced based on your drawings, but also can be customized according to your details requests. whether a small family farm or a large-scale livestock farm, we will do you the best proposal. For example, if your site is small, we will provide a compact but practical shed plan, if your site is large plus expect large-scale breeding, we will provide a spacious, comfortable and fully function shed plan.

Roof panel and wall panel

single layer steel sheet, EPS sandwich panel, rockwool sandwich panel, PU sandwich panel.

Ventilation System

1. Ventilation openings: Open a sufficient number of ventilation openings on both sides and the roof of the cattle shed to promote air circulation.
2. Fans: Install exhaust fans and intake fans of appropriate power, and adjust the operation intelligently according to the season and the temperature and humidity conditions inside the cattle shed.

Supporting equipment services

We can provide headlock, free-stall, fences, fans.

Features:



Open side wall shed

This kind shed usually build in countries where the temperature range is from 15 °C to 25 °C. this shed with single-layer steel sheet as roof panel. steel fence around the shed instead of the wall panel. this kind shed is economical

Semi-open wall shed	This kind shed usually build in countries where the temperature range is from 25 °C to 36 °C. this shed with steel sheet+glasswool roller as roof panel or EPS/rockwool/PU sandwich panel as roof.. steel fence around the side wall of shed instead of the wall panel. steel sheet as end wall panel.When the temperature is high in summer, fixed curtains on the side walls to provide shade and cool down
closed shed	This kind shed usually build in countries where the temperature range is below 15 °C in winter or over 36 °C in summer. this shed with EPS/rockwool/PU sandwich panel as roof. panel and wall panel.. the ventilator will be on roof for ventilation.

Technical Parameters:

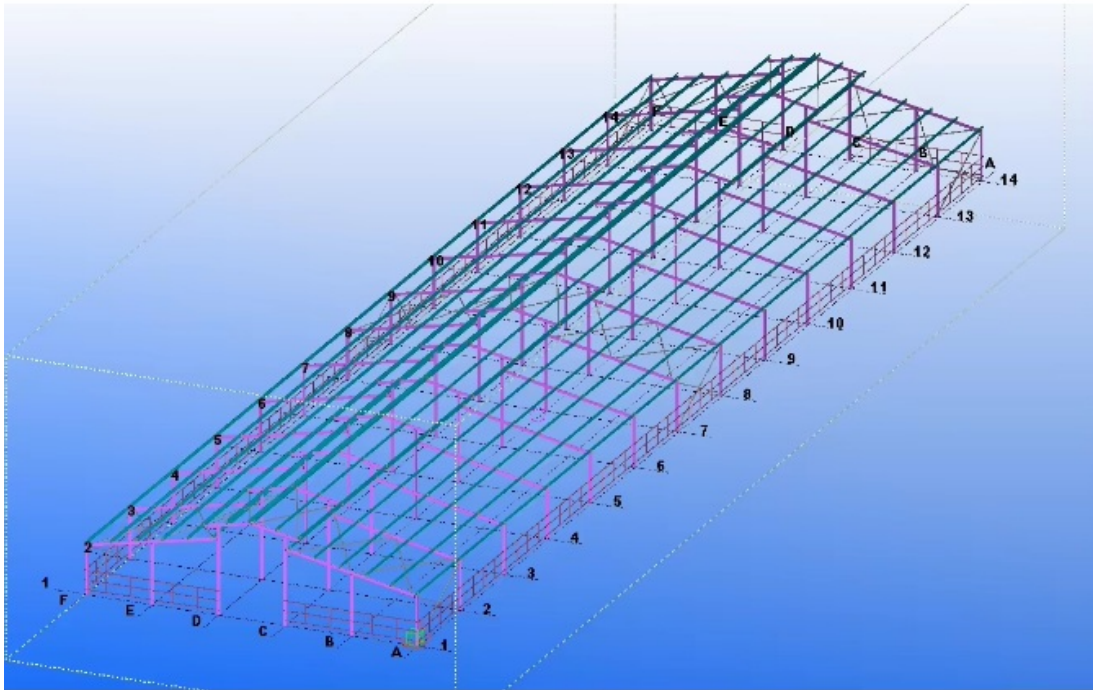

Applications:

The **BAODU Steel Warehouse** is a versatile and durable solution for various product application occasions and scenarios. With its high-quality **Steel Structure Frame Welded** construction, this warehouse offers a long fatigue life and requires low maintenance, making it ideal for a wide range of uses.

Originating from **Hebei, China**, this **Steel Warehouse** is certified with **ISO9001** and **C E**, ensuring its quality and reliability. The **reasonable price** and **flexible Minimum Order Quantity** make it accessible to different customers with varying needs.

Whether you need a warehouse, workshop, hangar, hall, or any other steel structure application, the **BAODU Steel Warehouse** is a perfect fit. Its **easy installation** process saves time and effort, while the **high durability** guarantees a long-lasting solution.

With a **Supply Ability** of 10000 Square Meter per Month, this steel warehouse can meet your demands in a timely manner. The **21 days Delivery Time** ensures quick availability, allowing you to proceed with your projects without delays.

For packaging, the steel frame packing is used to prevent damage during transportation, ensuring that your goods arrive safely. Additionally, special packing can be arranged based on your specific requirements.

When it comes to payment terms, options such as L/C, D/A, D/P, T/T, Western Union, and MoneyGram provide flexibility and convenience for customers worldwide.

In conclusion, the **BAODU Steel Warehouse** is a reliable, cost-effective, and easy-to-install solution for various product application occasions and scenarios. Whether you need a steel warehouse, workshop, hangar, hall, or any other steel structure, this product ticks all the boxes.

Support and Services:

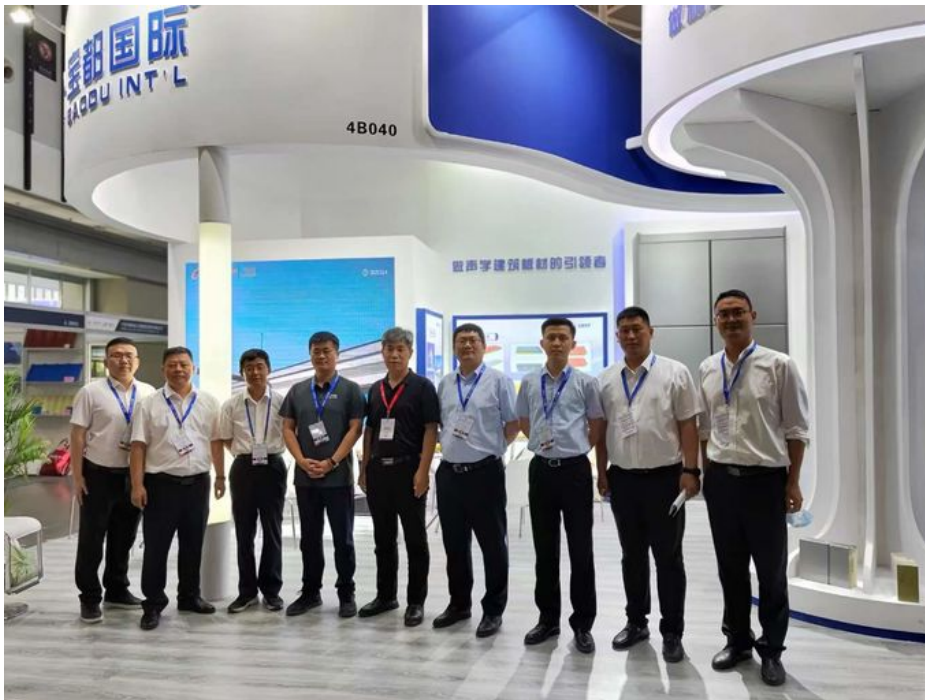

The Prefab Steel Warehouse product comes with comprehensive Product Technical Support and Services to ensure smooth installation and operation. Our team of experts is available to provide guidance and assistance throughout the process, from initial planning to final execution.

Our services include:

Technical consulting to help determine the best solution for your specific needs.

On-site support for installation and setup to ensure proper implementation.

Training sessions for your staff to familiarize them with the product and maximize efficiency.

Ongoing customer support to address any issues or questions that may arise.

Packing and Shipping:



FAQ:

Q: What is the brand name of the Prefab Steel Warehouse?

A: The brand name of the Prefab Steel Warehouse is BAODU.

Q: Where is the Prefab Steel Warehouse manufactured?

A: The Prefab Steel Warehouse is manufactured in Hebei, China.

Q: What certifications does the Prefab Steel Warehouse have?

A: The Prefab Steel Warehouse is certified with ISO9001 and CE.

Q: What is the minimum order quantity for the Prefab Steel Warehouse?

A: The minimum order quantity for the Prefab Steel Warehouse is discussible.

Q: What are the packaging details for the Prefab Steel Warehouse?

A: In general, for steel structure, we use steel frame packing to keep goods from being broken. For sandwich panel and color steel sheet, we use plastic packing. Special packing will be according to clients' requirements.

Q: What is the delivery time for the Prefab Steel Warehouse?

A: The delivery time for the Prefab Steel Warehouse is 21 days.

Q: What are the payment terms accepted for the Prefab Steel Warehouse?

A: The accepted payment terms for the Prefab Steel Warehouse are L/C, D/A, D/P, T/T, Western Union, and MoneyGram.

Q: What is the supply ability for the Prefab Steel Warehouse?

A: The supply ability for the Prefab Steel Warehouse is 10000 Square Meter/Square Meters per month.B

Company

Baodu International Advanced Construction Material Co., Ltd was established in January 2010 with the office in Beijing and factory in Hebei, China. Baodu is a designer, manufacturer, supplier and exporter of industrial noise comprehensive treatment, steel structure, sandwich panel and prefab house. Baodu has an annual output of 6 million square meters of acoustic sandwich panels, 100000 tons of

steel structures and 1 million square meters of floor decking sheet. The products are sold in more than 30 countries and regions around the world. Baodu has a professional design team with more than 10 years' experience, including 5 senior engineers, 20 engineers, and 35 technicians. Baodu has several energy saving and environment protection intellectual property rights, construction and environment protection design qualification, CE certification and Russian GOST certification etc. Baodu participated in the military parade village project for the 60th anniversary of China and project of Beijing Daxing International Airport. Under the guidance of China's "one belt, one road" strategy, Baodu has also undertaken overseas projects such as the project of Thar,Pakistan coal fired power plant, Hasyan Dubai power plant and so on. Finally, welcome your coming to Baodu for a visit and cooperation!



Baodu International Advanced Construction Material Co., Ltd.



+86 13717927965



chunlei.song@baodu.com



baodupanel.com

Room 1101, Building 6, Yard 9, Hongye Road, Daxing District, Beijing