

Modular Prefabricated Steel Warehouse Large Span Metal Building Space

Our Product Introduction

for more products please visit us on baodupanel.com

Basic Information

- Place of Origin: Hebei, China
- Brand Name: BAODU
- Certification: ISO9001, CE
- Model Number: Steel Warehouse
- Minimum Order Quantity: Discussible
- Price: Reasonable
- Packaging Details: In general, for steel structure, we use the steel frame packing to keep goods not to be broken. For sandwich panel and color steel sheet, we use the plastic packing. If the clients need special packing will according to their requirements.
- Delivery Time: 21 days
- Payment Terms: L/C, D/A, D/P, T/T, Western Union, MoneyGram
- Supply Ability: 10000 Square Meter/Square Meters per Month



Product Specification

- Roof & Wall Panel: Color Steel Veneer, Rockwool Sandwich Panel, PU Sandwich Panel Etc
- Surface Treatment: Hot Dip Galvanised Or Painted
- Keyword: Steel Structure Building Warehouse
- Door: Sliding Door, Rolling Door, Shutter Single Door, Color Steel
- Maintenance: Low
- Processing Service: Bending, Welding, Decoiling, Cutting, Punching
- Durability: High
- Application: Steel Storage, factory Or Logistic Warehouse
- Product Name: High Quality Large Span Metal Building Space Prefab Steel Structure Warehouse Workshop

Product Description

High Quality Large Span Metal Building Space Prefab Steel Structure Warehouse Workshop

Product Description:



Features:

Warehouse

Steel structure warehouse feature:

1. Light weight, high strength, large span;
2. Quality certification ISO:9001:2008
3. Used widely, used as factory, warehouse, office building, aircraft hangar etc;
4. Easy move, recycle, environmentally;
5. Short construction period, lower cost;
6. Structural durabilities, easy maintenance.

Workshop

Characteristics of steel structure workshop:

1. Light weight, high strength, large span;
2. Quality certification ISO:9001:2008
3. Short construction period, lower cost;
4. Easy move, recycle, environmentally;
5. Used widely, used as factory, warehouse, office building, aircraft hangar etc;
6. Structural durables, easy maintenance.

Technical Parameters:

Name	Steel Structure Building
Main Material	Q235 - Q420 Welded H Beam And Hot Rolled Section Steel
Surface	Painting Or Galvanizing
Roof And Wall Panel	EPS Sandwich Board, Single Corrugated Steel Plate, Glass Cotton Colored Board for Customers' Choice
Window	PVC Or Aluminum Alloy
Door	Sliding Door Or Rolling Shutter Door

Service	Design	We have experienced designers to design.
	Manufacture	We can manufacture all kinds of steel structure products according to customers'needs.
	Installation	We provide detailed drawings to ensure installation. It also provides installation, supervision and training services. We can also send a team of engineers to guide or install on site.
Packing	1. Steel structure components will be in nude packaging with proper protection. .Sandwich panels will be covered with plastic film. 3. Bolts and other accessories will be loaded into wooden boxes. 4. Container Drying Treatment. 5. According to customer's requirement	
Quality Inspection	Factory Self-inspectionCustomer Inspection Third Party Inspection	

If you are interested in our steel structure , please give us the following information:

- 1 Location (where will be built?) _____country, area
- 2 Size: Length*width*height _____mm*_____mm*_____mm
- 3 wind load (max. Wind speed) _____kn/m2, _____km/h, _____m/s
- 4 snow load (max. Snow height)_____kn/m2, _____mm
- 5 anti-earthquake _____level
- 6 brickwall needed or not If yes, 1.2m high or 1.5m high
- 7 thermal insulation If yes, EPS, fiberglass wool, rockwool, PU sandwich panels will be suggested; If not, the metal steel sheets will be ok. The cost of the latter will be much lower than that of the former.
- 8 door quantity & size _____units, _____(width)mm*_____(height)mm
- 9 window quantity & size _____units, _____(width)mm*_____(height)mm
- 10 crane needed or not If yes, _____units, max. Lifting weight_____tons; Max. Lifting height _____m.

Applications:



Steel structure warehouse

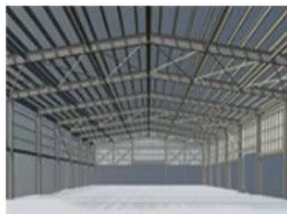

Steel structure factory building



Steel structure building



Steel structure garage/hangar



Steel structure house



Steel structure livestock house

The Steel Warehouse by BAODU is a versatile building that can be used for multiple applications. It is perfect for storage purposes as it is spacious and has a high load-bearing capacity. It is also suitable for use as an industrial steel workshop, hangar, or hall. The building can be customized according to the user's needs and requirements, and it comes with different door options such as sliding door, rolling door, shutter single door, and color steel.

The Steel Warehouse is made of high-quality galvanized steel that has excellent durability and can withstand harsh weather conditions. It is also resistant to corrosion, making it a long-lasting solution for commercial and industrial use. The building is designed to be easy to install, and it comes with detailed design drawings that can be used for installation. The drawing design options include SAP2000, AutoCAD, PKPM, 3D3S, and TEKLA.

BAODU Steel Warehouse is a highly secure building that is designed to keep your goods and equipment safe. It is suitable for use in different industries and can be customized to meet specific requirements. The building is also designed to be weather-resistant, making it ideal for use in different environmental conditions. The Steel Warehouse comes with packaging options that ensure the goods are well protected during transportation. The packaging options include steel frame packing, plastic packing, and customized packaging options based on the client's requirements.

BAODU Steel Warehouse has a reasonable price, and the minimum order quantity is negotiable. The delivery time is 21 days, and the payment terms include L/C, D/A, D/P, T/T, Western Union, and MoneyGram. The supply ability is 10000 Square Meter/Square Meters per Month, making it a readily available option for different users worldwide.

Support and Services:

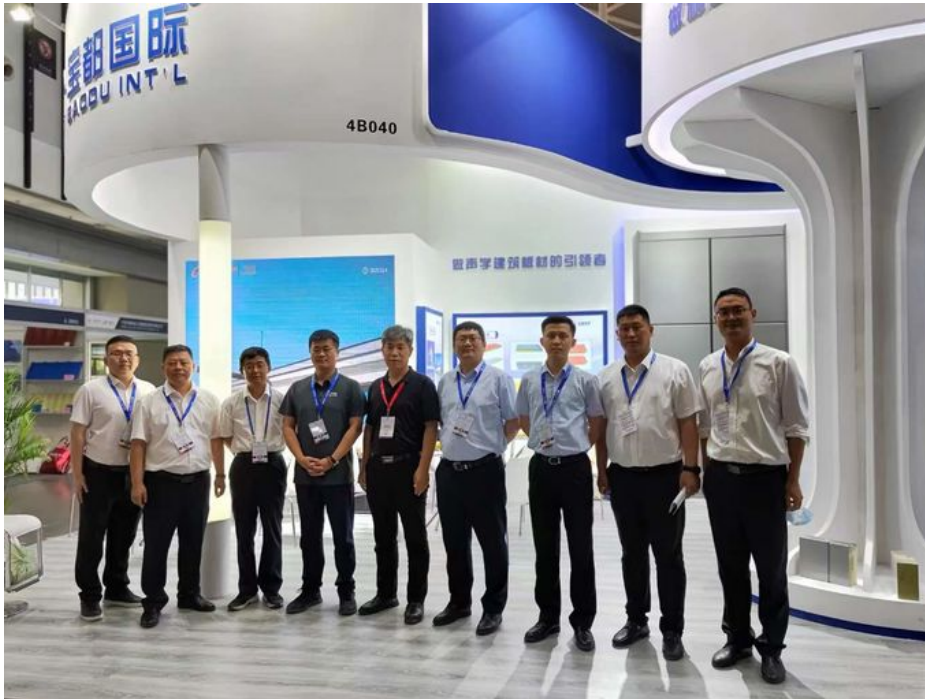

Our Prefab Steel Warehouse product comes with comprehensive technical support and services to ensure that you have a hassle-free experience. We offer:

Expert consultation on the design and customization of your warehouse

Assistance with obtaining necessary permits and certifications

Installation services by experienced professionals

Ongoing maintenance and repair services to keep your warehouse in optimal condition

24/7 customer support for any questions or issues that may arise

We pride ourselves on providing top-notch technical support and services to all of our customers. Contact us to learn more about how we can help you with your Prefab Steel Warehouse needs.

Packing and Shipping:



Product Packaging:

All steel components are packed in bundles and secured with steel straps.

The wall and roof panels are packed in bundles and marked for easy identification.

All hardware and fittings are packed in one package.

The packaged components are then loaded onto pallets or in containers for shipping.

Shipping:

The packaged components are shipped directly from our manufacturing facility to the customer's site.

Shipping times may vary depending on the customer's location.

We work with trusted shipping partners to ensure timely and safe delivery.

Customers are responsible for unloading the shipment upon arrival.

FAQ:

Q: What is the brand name of this product?

A: The brand name of this product is BAODU.

Q: Where is this steel warehouse produced?

A: This steel warehouse is produced in Hebei, China.

Q: What certifications does this steel warehouse have?

A: This steel warehouse has the ISO9001 and CE certifications.

Q: What is the minimum order quantity for this product?

A: The minimum order quantity for this product is discussible.

Q: What are the payment terms for purchasing this product?

A: The payment terms for purchasing this product include L/C, D/A, D/P, T/T, Western Union, and MoneyGram.

Q: What is the delivery time for this product?

A: The delivery time for this product is 21 days.

Q: What is the packaging method for this product?

A: In general, for steel structure, we use the steel frame packing to keep goods not to be broken. For sandwich panel and color steel sheet, we use the plastic packing. If the clients need special packing, we will according to their requirements.

Q: What is the supply ability of this product?

A: The supply ability of this product is 10000 Square Meter/Square Meters per month.

Q: What is the price of this product?

A: The price of this product is reasonable.



Baodu International Advanced Construction Material Co., Ltd.



+86 13717927965



chunlei.song@baodu.com



baodupanel.com

Room 1101, Building 6, Yard 9, Hongye Road, Daxing District, Beijing