

20ft Flat Pack Foldable Container House With Hot And Cold Water System

Our Product Introduction

for more products please visit us on baodupanel.com

Basic Information

- Place of Origin: Hebei, China
- Brand Name: BAODU
- Model Number: Container House
- Minimum Order Quantity: Discussible
- Price: Reasonable
- Packaging Details: In general, for steel structure, we use the steel frame packing to keep goods not to be broken. For sandwich panel and color steel sheet, we use the plastic packing. If the clients need special packing will according to their requirements.
- Delivery Time: 15 days
- Payment Terms: L/C, D/A, D/P, T/T, Western Union, MoneyGram
- Supply Ability: 100 Unit/Units per Week



Product Specification

- Product Name: Office Steel Structure Frame Welded Flat Pack Container House With Hot And Cold Water System
- After-sale Service: Online Technical Support
- Size: 20ft/40ft
- Decoration: Optional
- Insulation: Heat Insulation
- Window: Aluminum Alloy Window
- Keyword: Container House
- Lifespan: 10 Years
- Highlight: **Flat Pack Foldable Container House, 20ft Foldable Container House, 20ft flat pack container house**

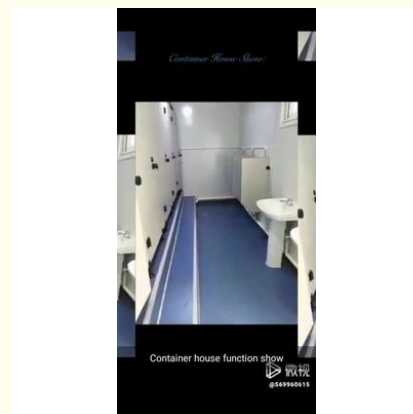

Product Description

Office Steel Structure Frame Welded Flat Pack Container House With Hot And Cold Water System

Product Description:

Container House is a prefabricated and folding house made of shipping containers. It features a contemporary design style and is made of sandwich panel and steel, making it waterproof for the whole house. The windows are made of aluminum alloy and optional furniture is available.

This shipping containers house is a perfect solution for a variety of applications, such as a temporary office, accommodation, mobile office, camp site, etc. It has all the advantages of a prefabricated and folding house, including easy installation, transportation, expandability, low cost, and environmental protection.

Container House is highly customizable and has a variety of options available. Choose from a wide range of furniture and colors to create the perfect home for you! Enjoy the convenience of a folding container house today!

Features:

Low construction cost: Compared with traditional brick-concrete structure houses, the construction cost of container houses is lower. This is because containers can be produced in a production line and can be stacked together during transportation, reducing transportation costs and space occupancy.

Strong durability: The main structure of the container house is composed of steel materials, which has very strong durability and wind resistance and earthquake resistance. At the same time, the shell of the container house is treated with special anti-corrosion treatment to prevent rust and corrosion.

Strong spatial plasticity: Because the size and shape of the container house can be adjusted according to needs, it has strong spatial plasticity. The area of the house can be extended or reduced by splicing, stacking, etc.

Simple and fast: the construction speed of container houses is very fast, and it can be completed after several links such as prefabrication, processing, and assembly. At the same time, due to its modular design, disassembly and migration are also very convenient.

Environmental protection and energy saving: the materials of container houses can be recycled and reused, and will not produce a lot of construction waste, while energy consumption and carbon emissions can be reduced by improving insulation materials and adopting new energy equipment.

Applications:

BAODU's Container House is the perfect solution for a variety of applications such as office building, expandable container house, prefabricated container house, shipping containers house, container home and container house for sale. It is designed with a contemporary style, and is made with high quality materials to ensure quality and durability. It has hot and cold water systems, and furniture can be added optionally. The minimum order quantity is discussible, and the price is reasonable. The packaging is secure and can be customized according to the customer's requirements. Delivery time is 15days, and payment terms include L/C, D/A, D/P, T/T, Western Union, and MoneyGram. BAODU has a weekly supply capacity of 100 units, and provides online technical support for after-sales service.

Customization:

BAODU Container House - Expanding Your Home Possibilities

Discover the possibilities of an expandable container house from BAODU! Our container houses are designed to be easily customizable, with features such as aluminum alloy window, optional decoration, optional air conditioner, and a modular structure. With a lifespan of 10 years, they are built to last.

Brand Name: BAODU

Model Number: Container House

Place of Origin: Hebei, China

Minimum Order Quantity: Discussible

Price: Reasonable

Packaging Details: In general, for steel structure, we use the steel frame packing to keep goods not to be broken. For sandwich panel and color steel sheet, we use the plastic packing. If the clients need special packing will according to their requirements.

Delivery Time: 15days

Payment Terms: L/C, D/A, D/P, T/T, Western Union, MoneyGram

Supply Ability: 100 Unit/Units per Week

Lifespan: 10 Years

Window: Aluminum Alloy Window

Decoration: Optional

Air Conditioner: Optional

Structure: Modular

Enhance your living space with BAODU's expandable container house. Contact us today to learn more.

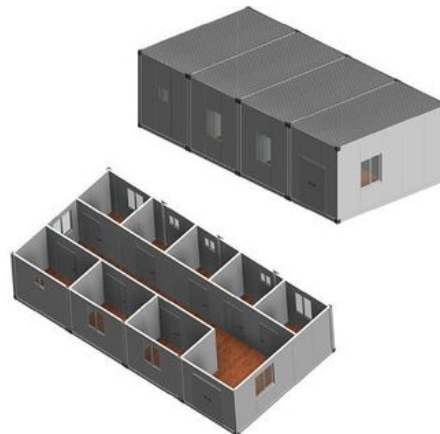
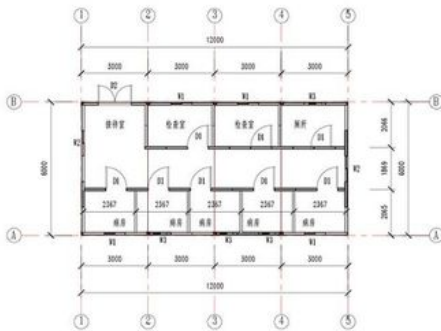
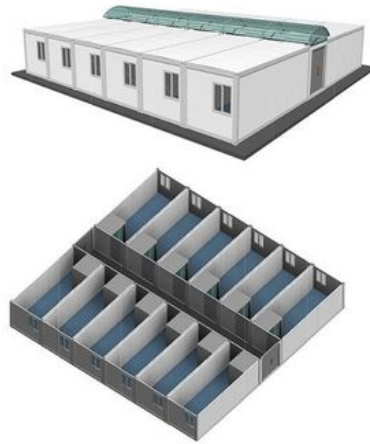
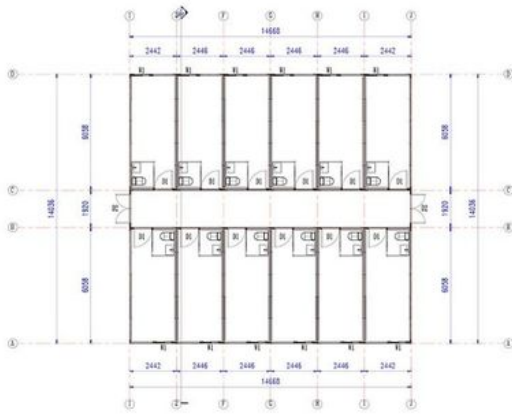

Support and Services:

Container House provides comprehensive technical support and service. Our experienced team of technical experts is available around the clock to provide you with the best possible service. We provide a full range of services, including troubleshooting, installation, maintenance, upgrades, and more. Our technical team is knowledgeable and experienced in all aspects of Container House products and can provide you with the support you need.

Packing and Shipping:

Packaging and Shipping of Container House

Container houses are shipped via flatbed truck or trailer. The container house is securely strapped to the flatbed to ensure there is no movement during transit. The container house is then transported to the desired location and unloaded at the site. The container house is then lifted onto the foundation and secured.

FAQ:

Q1: What is the brand of this container house?

A1: This container house is BAODU brand.

Q2: What is the model of this container house?

A2: The model of this container house is Container House.

Q3: Where is the origin of this container house?

A3: This container house is from Hebei, China.

Q4: What is the minimum order quantity for this container house?

A4: The minimum order quantity is discussible.

Q5: What is the payment terms for this container house?

A5: The payment terms are L/C, D/A, D/P, T/T, Western Union, MoneyGram.



Baodu International Advanced Construction Material Co., Ltd.



+86 13717927965



chunlei.song@baodu.com



baodupanel.com

Room 1101, Building 6, Yard 9, Hongye Road, Daxing District, Beijing